

- **Application range** - Internal grooving, Profiling, Threading and Boring at $\varnothing 8\text{mm} \sim \varnothing 16\text{mm}$
- **Features**
 - Strong clamping system and specially designed insert are suitable for small diameter machining.
 - Three kinds of inserts can be clamped in one holder for various operations
 - Long tool life due to good toughness substrate with new TiAlN coating
 - Accurate ground insert ensures high precision machining

NFTIH



NFTF
NFTT
NFTG

New Fine Tool Holders (Steel & Carbide Shank)

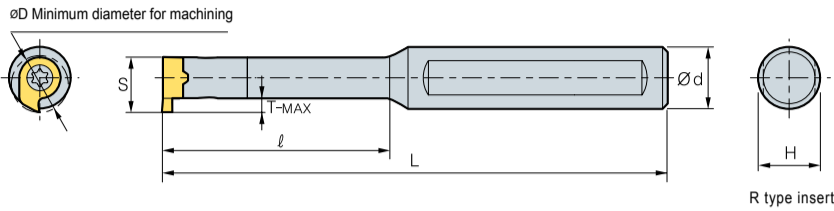

Designation	£	øD	ød	L	ℓ	T-MAX	H	S	Inserts			Screw	Wrench
									NFTG : Grooving	NFTT : Threading	NFTF : Forming		
NFTIH 08206C	£87.43	8	6	65	-	1.0	4	4.8					
08212C	£108.91	8	12	70	16	1.0	10	4.8	NFTG08			PTKA02508	TW08P
08312C	£108.91	8	12	80	24	1.0	10	4.8	NFTT08				
08312S	£64.49	8	12	80	24	1.0	10	4.8	NFTF08				
08412C	£111.79	8	12	90	32	1.0	10	4.8					
08512C	£120.38	8	12	100	40	1.0	10	4.8					
11208C	£93.16	11	8	80	-	2.3	7	6.7					
11212C	£97.45	11	12	75	22	2.3	11	6.7	NFTG11			PTKA03510	TW15P
11312C	£116.08	11	12	95	33	2.3	11	6.7	NFTT11				
11312S	£70.23	11	12	95	33	2.3	11	6.7	NFTF11				
11412C	£120.38	11	12	110	44	2.3	11	6.7					
11512C	£124.68	11	12	120	55	2.3	11	6.7					
14012C	£75.96	14	12	75	20	4.0	11	9.0					
14016C	£77.39	14	16	75	20	4.0	15	9.0					
14112C	£87.43	14	12	100	34	4.0	11	9.0					
14116C	£90.29	14	16	100	34	4.0	15	9.0					
14212C	£94.59	14	12	110	45	4.0	11	9.0	NFTG14			PTKA0412	TW15P
14216C	£103.18	14	16	110	45	4.0	15	9.0	NFTT14				
14312C	£103.18	14	12	130	64	4.0	11	9.0	NFTF14				
14312S	£75.96	14	12	130	64	4.0	11	9.0					
14316C	£146.17	14	16	130	64	4.0	15	9.0					
16312C	£141.88	16	12	130	48	4.3	11	10.2					
16312S	£85.98	16	12	130	48	4.3	11	10.2	NFTG16			PTKA0512	TW20P
16412C	£166.24	16	12	130	64	4.3	11	10.2	NFTT16				
16512C	£166.24	16	12	150	80	4.3	11	10.2	NFTF16				

(Steel Shank designation end in letter S & Carbide Shank ends in letter C)

Application examples

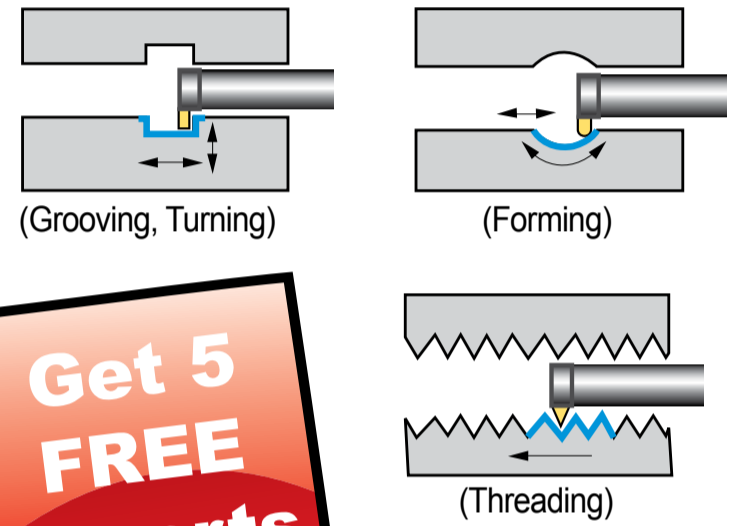

Get 5 FREE Inserts With Every Tool

New Fine Tool Internal Grooving Inserts

Application	Picture	Order Code	£	øD	b	r	S	g	ød ₂	t	Pitch	f	Configuration	
Grooving		NFTG 08075R		8	0.75			1.3						
		08085R			0.85			1.3						
		08095R			0.95			1.3						
		08121R	£8.82		1.21			1.3						
		08141R		1.41		7.75	1.3	5.9	3.85					
		08152R		1.52			1.3							
		08171R		1.71			1.3							
		08202R		2.02			1.3							
		11075R		0.75	11	0.75			1.8					
		11085R		0.85				1.8						
		11095R		0.95				1.8						
		11121R		1.21				2.6						
		11141R	£9.92	1.41		10.7	2.6	8.0	4.9					
		11152R		1.52			2.6							
		11171R		1.71			2.6							
		11202R		2.02			2.6							
		11202R-02		2.02		0.2	2.6							
		11252R		2.52			2.6							
		11302R		3.02			2.6							
		14075R		0.75	14	0.75			1.8					
14085R		0.85				1.8								
14095R		0.95				1.8								
14121R		1.21		13.5		4.3	9.0	5.85						
14141R	£9.92	1.41			4.3									
14152R		1.52			4.3									
14171R		1.71			4.3									
14202R		2.02			4.3									
14252R		2.52			4.3									
14302R		3.02			4.3									
16075R		0.75	16	0.75			1.8							
16085R		0.85				1.8								
16095R		0.95				1.8								
16121R		1.21			15.7	4.6	11	5.8						
16141R	£11.02	1.41			4.6									
16171R		1.71			4.6									
16202R		2.02			4.6									
16252R		2.52			4.6									
16302R		3.02			4.6									
16352R		3.52			4.6									
16402R		4.02			4.6									

New Fine Tool Internal Copying Inserts

Application	Picture	Designation	£	D	b	r	S	g	ød ₂	t	Configuration
Profiling/Copying		NFTF 08082R		8	0.82	0.41		1.3			
		08122R	£8.82		1.22	0.61	7.75	1.3	5.9	3.85	
		08182R			1.82	0.91		1.3			
		11082R		0.82	0.41		2.6			8	4.9
		11122R		1.22	0.61		2.6				
		11182R	£9.92	1.82	0.91	10.7	2.6				
		11202R		2.02	1.01		2.6				
		11302R		3.02	1.51		2.6				
		14122R		1.22	0.61		4.3			9	5.85
		14182R		1.82	0.91		4.3				
		14202R	£9.92	2.02	1.01	13.5	4.3				
		14222R		2.22	1.11		4.3				
		14302R		3.02	1.51		4.3				
		16182R		1.82	0.91		4.6			11	5.8
		16222R		2.22	1.11		4.6				
		16302R	£11.02	3.02	1.51	15.7	4.6				
16402R		4.02	2.01		4.6						

New Fine Tool Internal Threading Inserts

Application	Picture	Designation	£	øD	r	S	g	ød ₂	t	Pitch	f	Configuration	
Threading		NFTT 0805MR/L		8						0.5	1.0		
		0810MR/L	£8.82			7.75		6	3.85	1.0	1.0		
		0815MR/L								1.5	1.2		
		1110MR/L			11						1.5	1.2	
		1115MR/L				10.7		8	4.9	2.0	1.2		
		1120MR/L	£9.92							2.5	1.2		
		1125MR/L									2.5	1.2	
		1410MR/L			14						1.0	1.2	
		1415MR/L				13.5		9	5.85	1.5	1.2		
		1420MR/L	£9.92							2.0	1.2		
		1425MR/L									2.5	1.2	
		1610MR/L			16						1.0	1.2	
		1615MR/L				15.7		11	5.8	1.5	1.2		
		1620MR/L	£11.02							2.0	1.2		
		1625MR/L									2.5	1.2	
		1630MR/L									3.0	1.5	
1635MR/L									3.5	1.6			
1640MR/L									4.0	1.8			